



# Project Spotlights: Coleman Highline

## GENERAL CONTRACTOR

Devcon Construction

## ARCHITECT

Devcon Construction

## CATEGORY

Insulated Concrete Roofing Systems

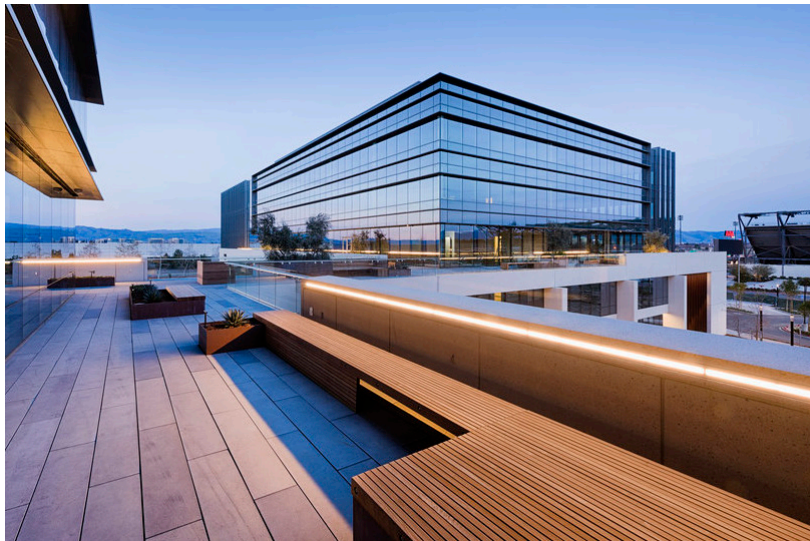

## ABOUT THE PROJECT

Next door to the new outdoor soccer stadium in San Jose, CA, we recently completed 1, 2, 3, and 4 building exterior walkways using Siplact Insulcel RT and Insulperm board for the Coleman Highline.

## THE SOLUTION

Cell-Crete sloped the flat structural concrete decks 1/4" per foot fall. The deck will support a raised pedestal paver system for outside seating and passageway between the 4 buildings.

